

FILE PLOTTED: 11/17/00

CADD FILE NAME: M:\DATA1\9904\FINAL\CK01.DWG

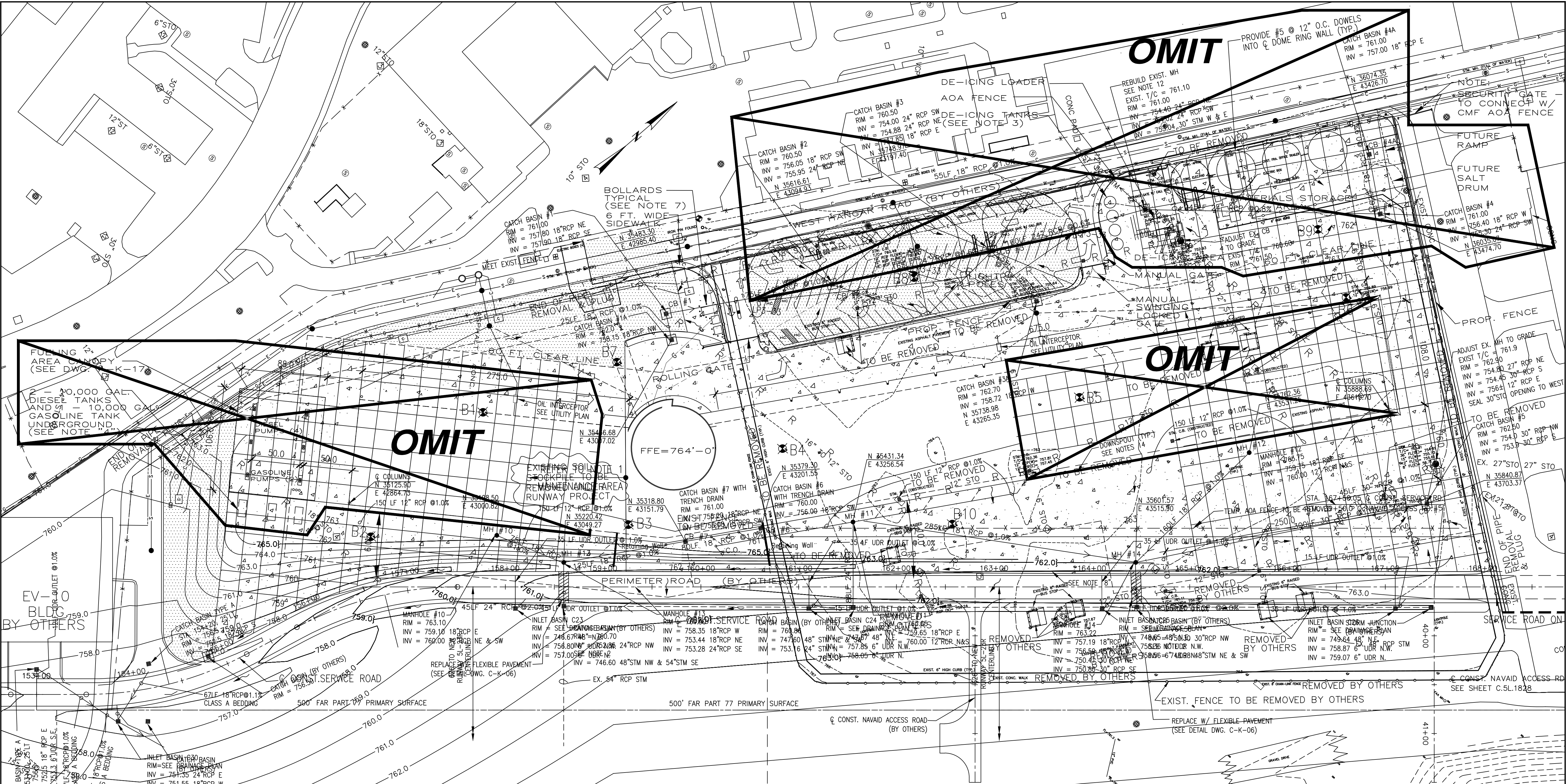

- NOTES:**
- SUBSTITUTE CONCRETE PAVEMENT TO ASPHALTIC PAVEMENT EXCEPT PUMP STATION AREA IF MAINTENANCE WING IS NOT BUILT.
 - CONNECT 24"/30" RCP INTO CATCH BASIN (BY OTHERS)
 - RING WALL FOUNDATION DETAIL FOR DEICING TANK, SEE DWG. S-K-09.
 - PIPING, FOUNDATION AND LAYOUT FOR UNDERGROUND TANK, SEE DWG. M-K-13.
 - FOR AOA FENCE AND GATES, SEE FENCING DETAILS DWG. C-K-06.
 - FOR SITE UTILITIES, SEE UTILITY PLAN DWG. C-K-05.
 - ALL EQUIPMENT, CARD READER, FIRE HYDRANT NEED TO BE PROTECTED WITH BOLLARD AT MAX. SPACE OF 10'-0" C/C.
 - REBUILD PERIMETER ROAD WEST SHOULDER AS NEEDED FOR POSITIVE DRAINAGE. SEE FLEXIBLE PAVEMENT REPAIR DETAIL DWG. C-K-06.
 - FOR TRANSFORMER PAD AND EMERGENCY GENERATOR PAD REQUIREMENTS FOLLOW VENDOR'S RECOMMENDATIONS. CONTRACTOR TO SUBMIT SHOP DRAWINGS FOR APPROVAL.
 - ALL CATCH BASIN TO BE O.D.O.T. STANDARD NO. 2-3 AND ALL MANHOLES TO BE O.D.O.T. STANDARD NO. 3 AS PER SPECIFICATION SECTION 02630.
 - FOR CATCH BASIN WITH TRENCH DETAIL, SEE DRAWINGS C-K-07 AND C-K-11.
 - MODIFY TO OPEN GRATE SIMILAR OR EQUAL TO EXISTING CATCH BASIN 50'± TO EAST.
 - REVISED DWG. DATED 11/00.
 - FOR DOWNSPOUT DETAILS SEE DWG. A-K-16 AND P-K-04.
 - CONNECT DOWNSPOUTS INTO 12" RCP LATERAL - SEE CONCRETE COLLAR DETAIL.

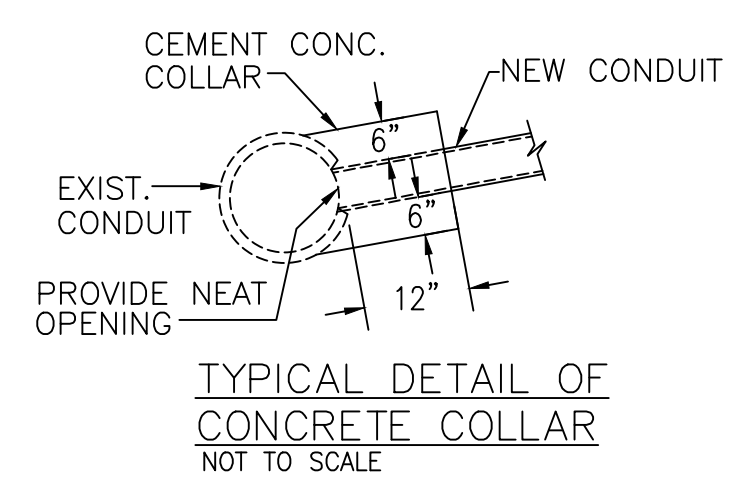
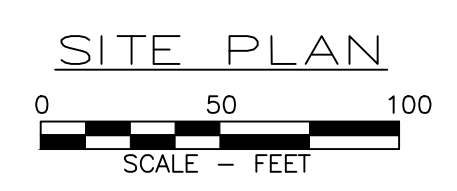
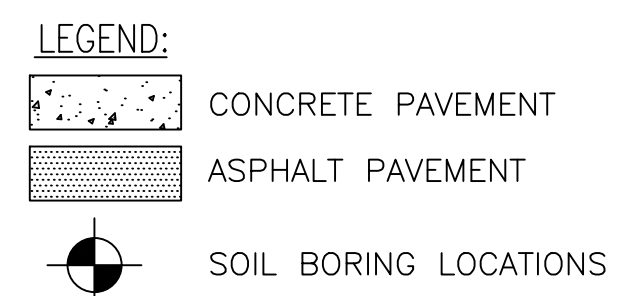

G & T Associates Inc.
Consulting Engineers
Strongsville, Ohio
Ph. (440) 572-0555

FOR INFORMATION ONLY:
OFFICIAL PLANS ARE THE HARD COPIES ISSUED BY THE OWNER

DESIGNED: RW	11/00	DRAWN: RL	11/00	CHECKED: KCP	11/00
REFERENCE NUMBERS			SCALE:		
SPECIFICATION FILE NUMBER:			AS NOTED		
JOB NUMBER:			DRAWING NUMBER:		
AIP NUMBER:			C-K-01		

1	12/12/03	ISSUE FOR RECORD, BULL. #D	
0	11/17/00	ISSUE FOR CONSTRUCTION BULL. #	
REV. #	REV. DATE	DESCRIPTION OF REVISION	INITIAL

**CITY OF CLEVELAND
DEPARTMENT OF PORT CONTROL
CLEVELAND HOPKINS INTERNATIONAL AIRPORT
CONSOLIDATED MAINTENANCE FACILITY
SITE PLAN**